



## INTERCHANGEABLE VARIABLE SPEED PULLEYS

### Verstellscheiben | Austausch Typen

Fabrikat / Brand	Type	R(iemen) / R (belt)	Ø a H7*	Ø b	Ø dw	Ø Dw	Ø Da	L
Lenze	11.104.05.6.1	22x6	14 - 19	68	47	117	120	72
Berges	F101sb	22x7	14 - 19 - 24	64	51	118		
Lenze	11.104.10.6.1	28x8	19 - 24	80	56	151	155	94
Berges	F151sb		19 - 24 - 28*	77	60	156	159	
Lenze	11.104.20.6.1	28x8 1)	24 - 28	90	64	176	180	108
Berges	F181sb		19 - 24 - 28*	77	62	141/181	184	
Lenze	11.104.30.6.1	37x10	28	104	72	215	220	130
Berges	F211.37sb		19 - 24 - 28	98	74	217		
Lenze	11.104.40.6.1	47x13	28 - 38	145	94	263,5	270	148
Berges	F211.47sb	47x12	19 - 24 - 28	98	74	217	220	130
	F250sb		28 - 38 - 42*	106	89	250	255	170
Lenze	11.104.50.6.1	55x16	38 - 42	145	98	292	300	180
Berges	F281sb	55x15	28 - 38 - 42*	106	98,5	292	296	
Lenze	11.104.70.6.1	70x18	42 - 48	190	121	351	360	220
Berges	F325sb		38 - 42 - 48	147	117	341	346	240

Bohrungen mit Passfedernuten nach DIN 6885 Bl. 1 (3\*)  
Bores with keyways are to DIN 6885 page 1 (3\*)

- 1) F181sb Riemen belt 37x10 ØDw=181  
F181sb Riemen belt 28x8 ØDw=141

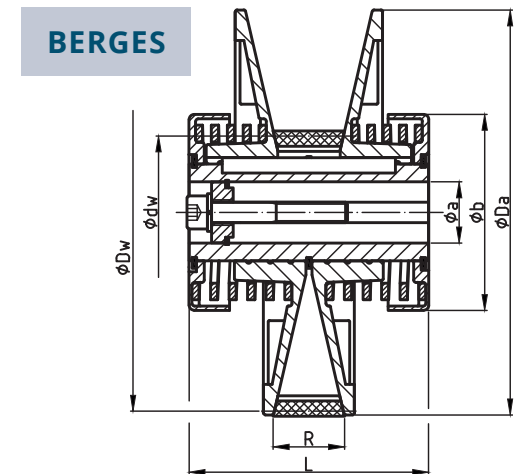
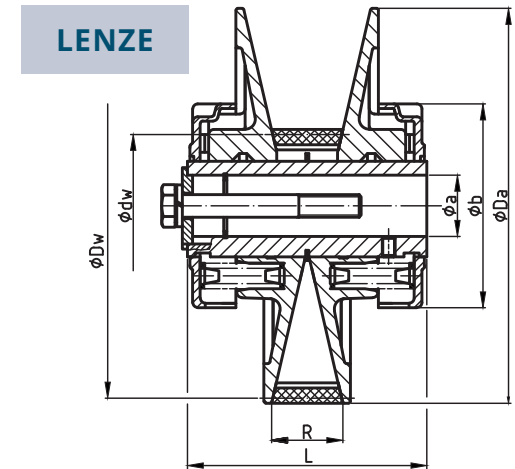

## INTERCHANGEABLE VARIABLE SPEED PULLEYS

### Verstellscheiben | Austausch Typen

Fabrikat / Brand	Type	R(iemen) / R (belt)	Ø a H7	Ø dw	Ø Dw	Ø Da	L
Lenze	11.101.05.1.1	22x6	14*	40	116	120	72
Berges	F101sb	22x7	11 - 14 - 24*	51	118	120	72
Lenze	11.101.10.1.1	28x8	19	69,5	160,5	165	94
Berges	F151sb	28x8	18 - 19 - 28*	60	156	159	94
Lenze	11.101.20.1.1	37x10	24	78	180	185	110
Berges	F181sb	37x10	14 - 24 - 28*	62	181	184	108
Lenze	11.101.30.1.1	47x13	28	92,5	218,5	225	130
Berges	F211.47sb	47x12	18 - 28 - 32*	74	217	220	130
Lenze	11.101.40.1.1 11.101.45.1.1	47x13	28	105,5	263,5	270	148
Berges	F235sb	37x10	18 - 28 - 32*	69	231	236	148
	F250sb	47x12	19 - 28 - 42*	89	250	255	170
Lenze	11.101.55.1.1	55x16	38	121	302	310	180
Berges	F281sb	55x15	22 - 38 - 42*	98,5	292	296	180
Lenze	11.101.65.1.1	70x18	38 / 42	142	351	360	196
Berges	F325sb	70x18	25 - 38 - 42 - 48	117	341	346	240
Lenze	11.101.80.1.1	70x18	42 / 48	162	366	375	200
Berges	F350sb	72x22	25 - 42 - 48 - 55*	123	339	346	240

Bohrungen mit Passfedernuten nach DIN 6885 Teil 1 (\* DIN 6885 Teil 3)  
Bores with keyways are to DIN 6885 part 1 (\* DIN 6885 part 3)

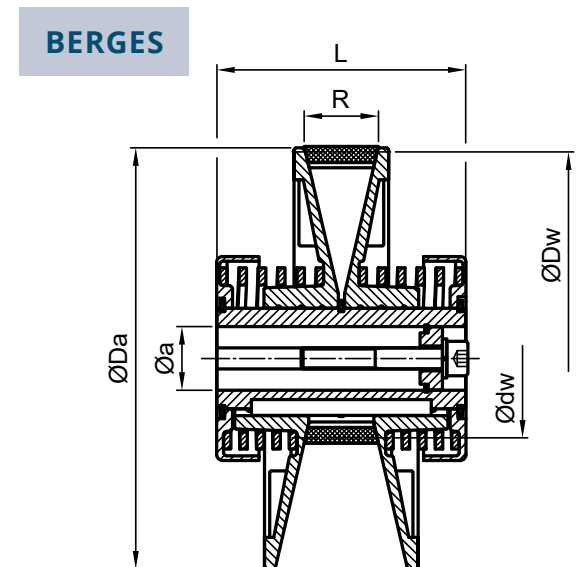
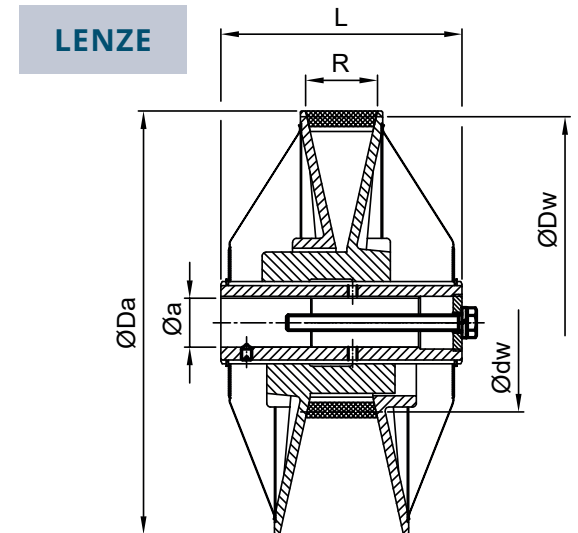

# INTERCHANGEABLE VARIABLE SPEED PULLEYS

## Verstellscheiben | Austausch Typen



LENZE

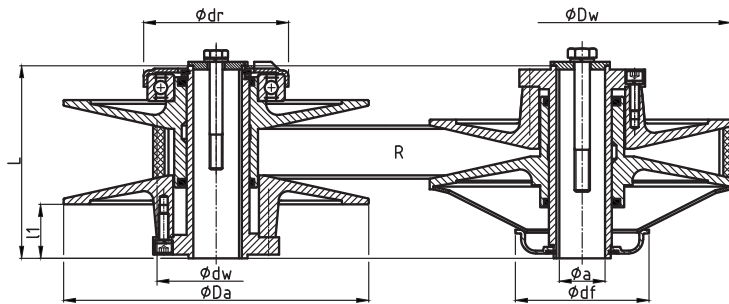

**Regelscheibe**  
control pulley

**Federscheibe**  
spring pulley

BERGES

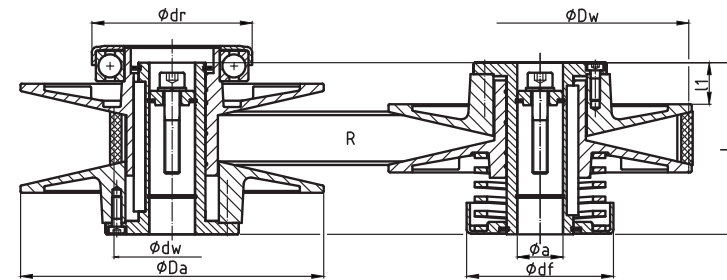

**Regelscheibe**  
control pulley

**Federscheibe**  
spring pulley

REGELSCHEIBE   CONTROL PULLEY									FEDERSCHEIBE   SPRING PULLEY								
Fabrikat / Brand	Type	$\phi a$ H7	$\phi Da$	$\phi dw$	$\phi Dw$	$\phi dr$	L	I1	R(iemen) / R (belt)	Type	$\phi a$ H7	$\phi Da$	$\phi dw$	$\phi Dw$	$\phi df$	L	I1
Lenze	11.213.10.910	14	102	41	99	59	65	20,2	14x5	11.213.10.920	14	102	41	99	45,5	65	20,2
Berges	R080b	11 - 14	91,4	38	90	55	50	11,9	17x5	F080b	11 - 14	91,4	38	90	44,5	50	11,9
Lenze	11.213.13.910	14 - 19 - 24*	130	54	127	79	95	30,5	22x6	11.213.13.920	14 - 19 - 24*	130	54	127	81	95	30,5
Berges	R100b		120	49,5	118,5	72	72	18,8	22x7	F100b		120	118,5	49,5	133,5	64	72
	R130b	135	133,5		F130b					135							
Lenze	11.213.16.910	19 - 24 - 28*	160	62	156	95	110	33	28x8	11.213.16.920	19 - 24 - 28*	160	62	156	93	110	33
Berges	R150b		159	61		84	90	21,8		F150b		159	61		77	90	21,8
Lenze	11.213.20.910	24 - 28	205	77	200	100	130	36	37x10	11.213.20.920	24 - 28	205	77	200	107	130	36
Berges	R210b	24 - 28 - 38	220	79	217	100	122	30,6		F210b	24 - 28 - 38	220	79	217	98	122	30,6
	R196b	19 - 24 - 28	198	69	196	84	110	27,7	33x10	F196b	19 - 24 - 28	198	69	196	90	110	27,7
Lenze	11.213.25.910	28 - 38 - 42	252	94	243,5	120	160	43,5	47x13	11.213.25.920	28 - 38 - 42	252	94	243,5	128	160	43,5
Berges	R250b	28 - 38 - 42*	255	90	250	116	145	36,1	47x12	F250b	28 - 38 - 42*	255	90	250	111	145	36,1
Lenze	11.213.31.910	38 - 42 - 48*	315	118	307	155	196	56	55x16	11.213.31.920	38 - 42 - 48*	315	118	307	135	196	56
Berges	R300b	38 - 42 - 48	305	110	300	146	185	49,6	51x16	F300b	38 - 42 - 48	305	110	300	147	185	49,6

# INTERCHANGEABLE VARIABLE SPEED PULLEYS

## Verstellscheiben | Austausch Typen



**LENZE**

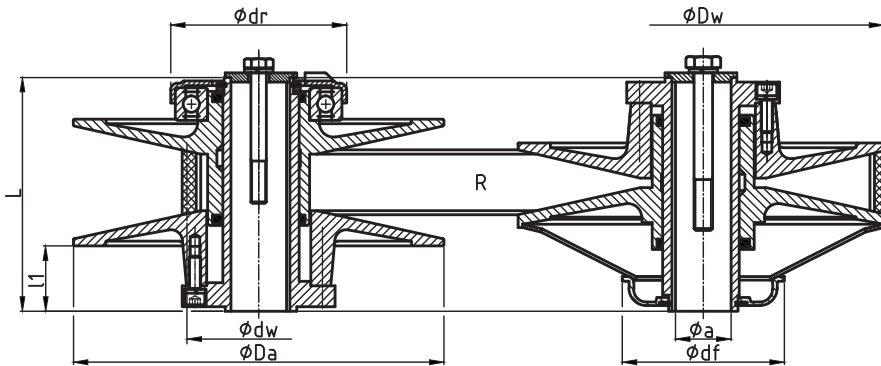

**Regelscheibe**  
control pulley

**Federscheibe**  
spring pulley

**BERGES**

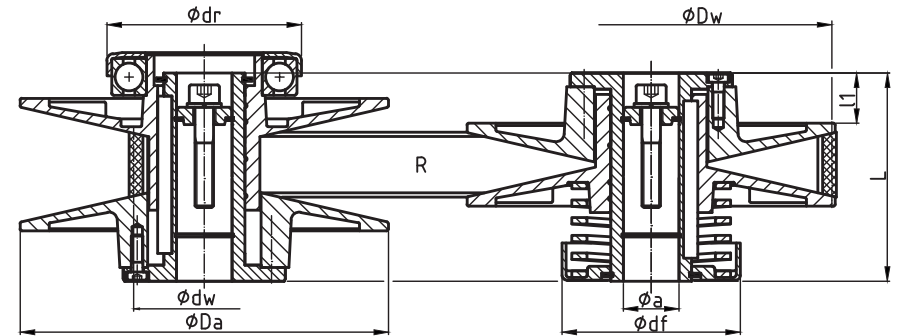

**Regelscheibe**  
control pulley

**Federscheibe**  
spring pulley

REGELSCHIEBE   CONTROL PULLEY									FEDERSCHIEBE   SPRING PULLEY								
Fabrikat / Brand	Type	$\phi a$ H7	$\phi Da$	$\phi dw$	$\phi Dw$	$\phi dr$	L	l1	R(iemen) / R (belt)	Type	$\phi a$ H7	$\phi Da$	$\phi dw$	$\phi Dw$	$\phi df$	L	l1
Lenze	11.115.17.910	14 - 19 - 24*	170	50	167	79	95	24	28x6	11.115.17.920	14 - 19 - 24*	170	50	167	64	95	24
Berges	R170b	19 - 24	170	61	168	84	90	21,7	28x8	F170b	19 - 24	170	61	168	77	90	21,7
Lenze	11.115.20.910	19 - 24 - 28*	200	59	196	95	110	28	32x8	11.115.20.920	19 - 24 - 28*	200	59	196	79	110	28
Berges	R196b	19 - 24 - 28	198	69	196	84	110	27,7	33x10	F196b	19 - 24 - 28	198	69	196	90	110	27,7
Lenze	11.115.24.910	24 - 28	240	70	235	100	130	33	40x10	11.115.24.920	24 - 28	240	70	235	82	130	33
Berges	R235b	19 - 24 - 28	236	69	231	100	122	30	37x10	F235b	19 - 24 - 28	236	69	231	98	122	30

Bohrungen  $\phi a$  H7 mit Passfedernuten nach DIN 6885 Bl. 1 (3\*) | Bores  $\phi a$  H7 with keyways are to DIN 6885 page 1 (3\*)

Maßänderungen vorbehalten! | Dimensions may be subject to alterations!



**BERGES Mechanics GmbH**

Peter Mitterhoferstraße 21  
I - 39025 Naturns (BZ)  
T +39 0473 66 73 72  
[commerciale@berges.eu](mailto:commerciale@berges.eu)



**BERGES ANTRIEBSTECHNIK GmbH & Co. KG**

Industriestraße 13  
D - 51709 Marienheide  
T +49 (0) 2264 17 - 0  
[sales@berges.eu](mailto:sales@berges.eu)

**EXPERTS IN MOTION**